

NOTES:

Existing - Refers to 1975 Zoning Ordinance.

Planned - Refers to planned 1,200' runway extension to the north for a full runway length of 6,600'.

This map is for illustrative purposes only. Actual location of zoning boundaries on specific parcels shall be field located by a Registered Land Surveyor.

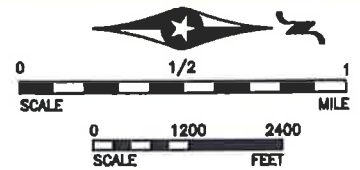

MAY 16, 2008 EXHIBIT B

**BOLTON & MENK, INC**  
 CONSULTING ENGINEERS & SURVEYORS  
 MANKATO, MN FARMONT, MN SLEEPY EYE, MN WILLMAR, MN  
 BURNSVILLE, MN CHASKA, MN RAMSEY, MN AMES, IA

**MANKATO REGIONAL AIRPORT**  
 CITY OF MANKATO, MINNESOTA

**ZONING MAP** PG. 23



**NOTES:**

Existing - Refers to 1975 Zoning Ordinance.

Planned - Refers to planned 1,200' runway extension to the north for a full runway length of 6,600'.

This map is for illustrative purposes only. Actual location of zoning boundaries on specific parcels shall be field located by a Registered Land Surveyor.

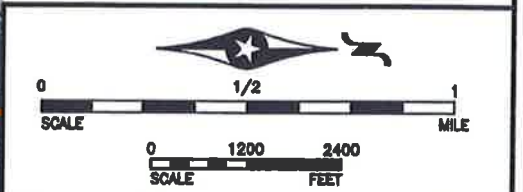

MAY 16, 2008 EXHIBIT C

**BOLTON & MENK, INC**  
 CONSULTING ENGINEERS & SURVEYORS  
 MANKATO, MN FARMONT, MN SLEEPY EYE, MN WILLMAR, MN  
 BURNSVILLE, MN CHASKA, MN RAMSEY, MN AMES, IA

**MANKATO REGIONAL AIRPORT**  
 CITY OF MANKATO, MINNESOTA

**ZONING MAP** PG. 24

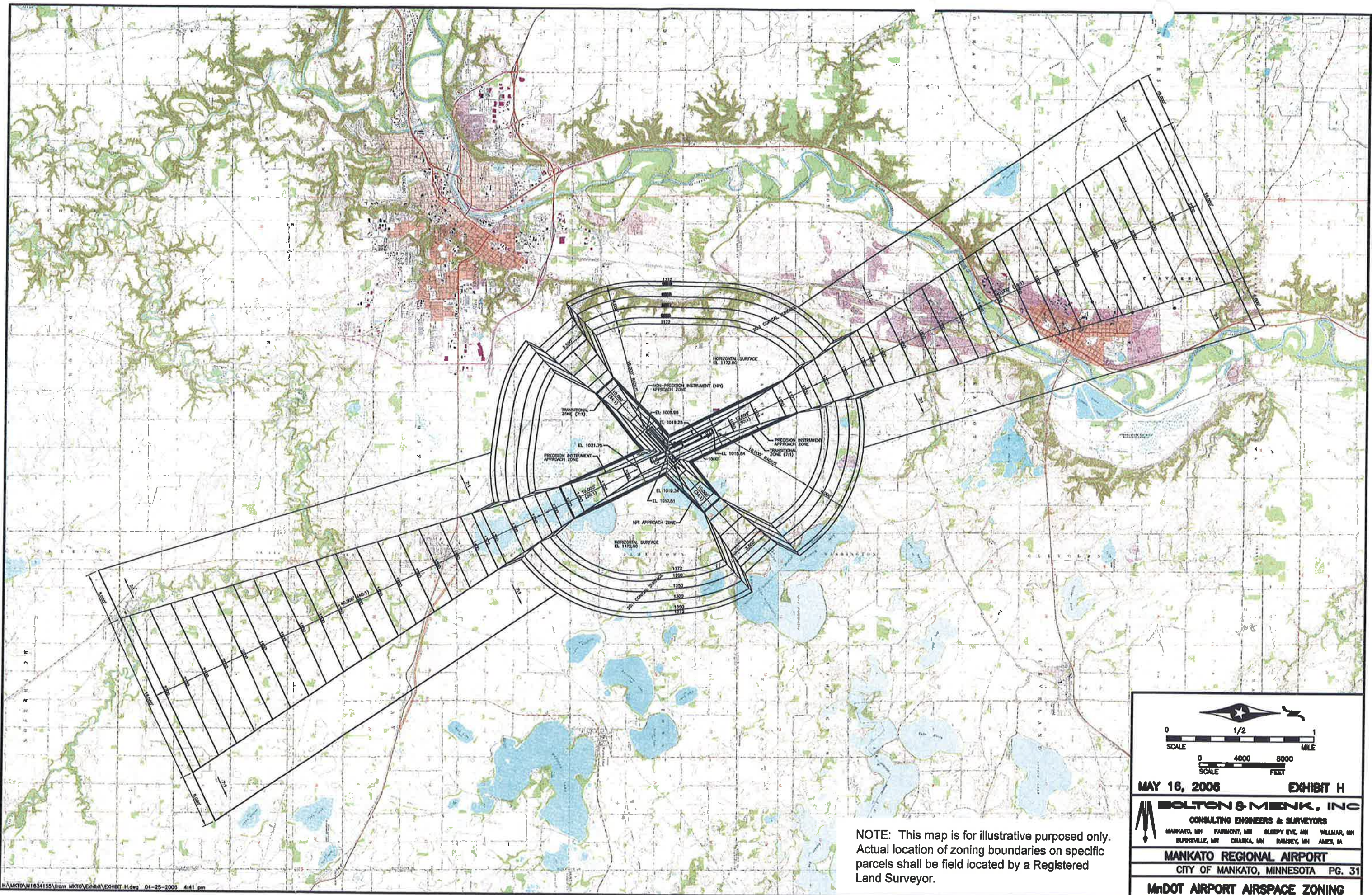

NOTE: This map is for illustrative purposes only. Actual location of zoning boundaries on specific parcels shall be field located by a Registered Land Surveyor.

  
 0 1/2 1  
 SCALE MILE  
 0 4000 8000  
 SCALE FEET

**MAY 16, 2006** **EXHIBIT H**

**BOLTON & MENK, INC**  
 CONSULTING ENGINEERS & SURVEYORS  
 MANKATO, MN    FAIRMONT, MN    SLEEPY EYE, MN    WILLMAR, MN  
 BURRISVILLE, MN    CHASKA, MN    RAMSEY, MN    AMES, IA

**MANKATO REGIONAL AIRPORT**  
 CITY OF MANKATO, MINNESOTA    PG. 31

**MnDOT AIRPORT AIRSPACE ZONING**

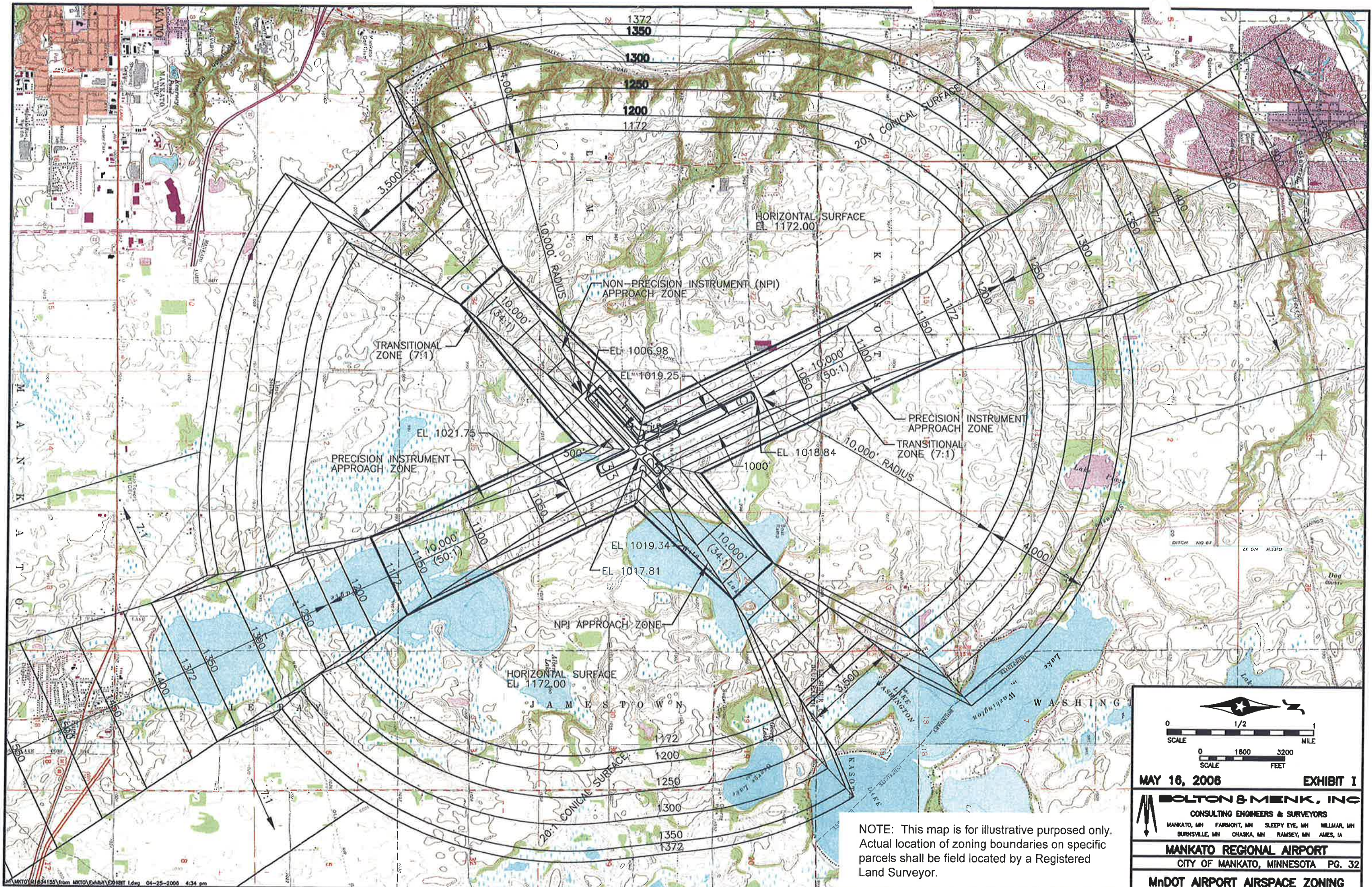

NOTE: This map is for illustrative purposes only. Actual location of zoning boundaries on specific parcels shall be field located by a Registered Land Surveyor.

0 1/2 1  
SCALE MILE

0 1600 3200  
SCALE FEET

MAY 16, 2006 EXHIBIT I

**BOLTON & MENK, INC**  
CONSULTING ENGINEERS & SURVEYORS  
MANKATO, MN FARMONT, MN SLEEPY EYE, MN WILLMAR, MN  
BURHYSVILLE, MN CHASKA, MN RAMSEY, MN AMES, IA

**MANKATO REGIONAL AIRPORT**  
CITY OF MANKATO, MINNESOTA PG. 32

**MnDOT AIRPORT AIRSPACE ZONING**